

당신은 Ronda 무브먼트를 쓰는 시계제조자가 조립한 시계를 구매하기로 결정하였습니다. 어떠한 시계도 Ronda Brand 아래서 생산 또는 유통되지 않았음을 유의해 주세요.

수리, 보증 클레임과 시계의 기능에 관련된 질문의 경우에, 구매자와 소비자는 반드시 그들의 리테일러나 시계 제조사에 연락해야 합니다. 그것에 대한 적절한 정보는 시계와 함께 제공된 판매 또는 보증서에서 찾을 수 있습니다.

디스플레이와 설정버튼 설명

디스플레이 요소

설정버튼

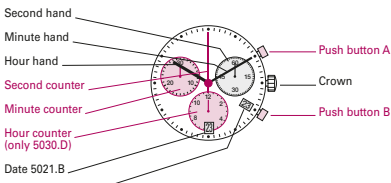

01

Chronograph: Basic function

(Start / Stop / Reset)

Example:

- 1 Start: Press push-button A.
- 2 Stop: to stop the timing, press push-button A once more and read the chronograph hands: **1h / 20min / 38 sec.**
- 3 Zero positioning: Press push-button B. (The chronograph hands will be reset to their zero positions.)

05

Chronograph: Accumulated timing

Example:

- 1 Start: (start timing)
- 2 Stop: (e.g. 15 min 5 sec following 1)
- 3 Restart: (timing is resumed)
- 4 Stop: (e.g. 5 min 12 sec following 3) = **20 min 17 sec** (The accumulated measured time is shown)
- 5 Reset: The chronograph hands are returned to their zero positions.

Please note:
* Following 4, the accumulation of the timing can be continued by pressing **push-button A** (Restart / Stop, Restart / Stop, ...).

06

Chronograph: Intermediate or interval timing

Example:

- 1 Start: (start timing)
- 2 Display interval: e.g. 20 minutes 17 seconds (timing continues in the background)
- 3 Making up the measured time: (The chronograph hands are quickly advanced to the ongoing measured time.)
- 4 Stop: (Final time is displayed)
- 5 Reset: The chronograph hands are returned to their zero position.

Please note:
* Following 2, further intervals or intermediates can be displayed by pressing **push-button B** (display interval / make up measured time, ...).

07

Setting the time

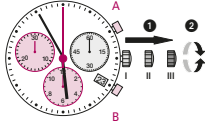

- 1* Pull out the crown to position III (the watch stops).
- 2 Turn the crown until you reach the correct time 8:45.
- 3* Push the crown back into position I.

Please note:
* In order to set the time to the exact second, 1 must be pulled out when the second hand is in position «60». Once the hour and minute hands have been set, 3 must be pushed back into position I at the exact second.

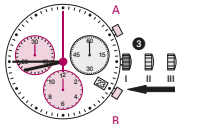

02

Adjusting the chronograph hands to zero position

Example:
One or several chronograph hands are not in their correct zero positions and have to be adjusted (e.g. following a battery change).

- 1 Pull out the crown to position III (all chronograph hands are in their correct or incorrect zero position).
- 2 Keep push-buttons A and B depressed simultaneously for at least 2 seconds (the second counter hand rotates by 360° → corrective mode is activated).

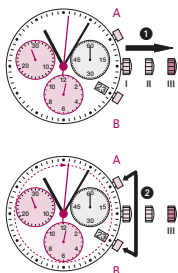

08

Setting the date/time following a battery change

Example:
- Date / time on the watch: 12 / 1:25 AM
- Present date / time: 4 / 8:30 PM

- 1 Pull out the crown to position II (the watch continues to run).
- 2 Turn the crown until yesterday's date appears [3].
- 3* Pull out the crown to position III (the watch stops).
- 4 Turn the crown until the correct date [4] appears.
- 5** Continue to turn the crown until the correct time 8:30 PM appears.
- 6 Push the crown back into position I.

Please note:
* To set your watch to the exact second, please refer to the chapter entitled «setting the time».
**Please observe the AM/PM clock rhythm.

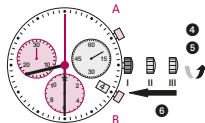
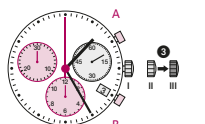
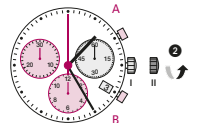
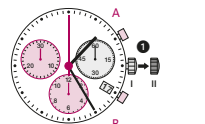

04

Adjusting the second counter hand

Single step ↖ A 1 x short
Continuous ↖ A long

Adjusting the next hand B

Single step ↖ A 1 x short
Continuous ↖ A long

Adjusting the hour counter hand at 5030.D (position 6h)

Single step ↖ A 1 x short
Continuous ↖ A long

Adjusting the next hand B

Single step ↖ A 1 x short
Continuous ↖ A long

Adjusting the minute counter hand (position 9h)

Single step ↖ A 1 x short
Continuous ↖ A long

Returning the crown to position I

Termination of the chronograph hands adjustment (can be carried out at any time).

